

Side View

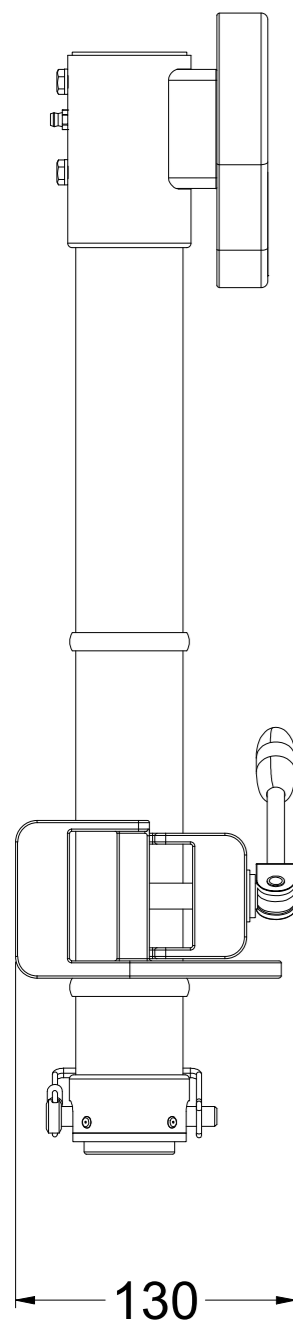

Travel Position without Base Plate

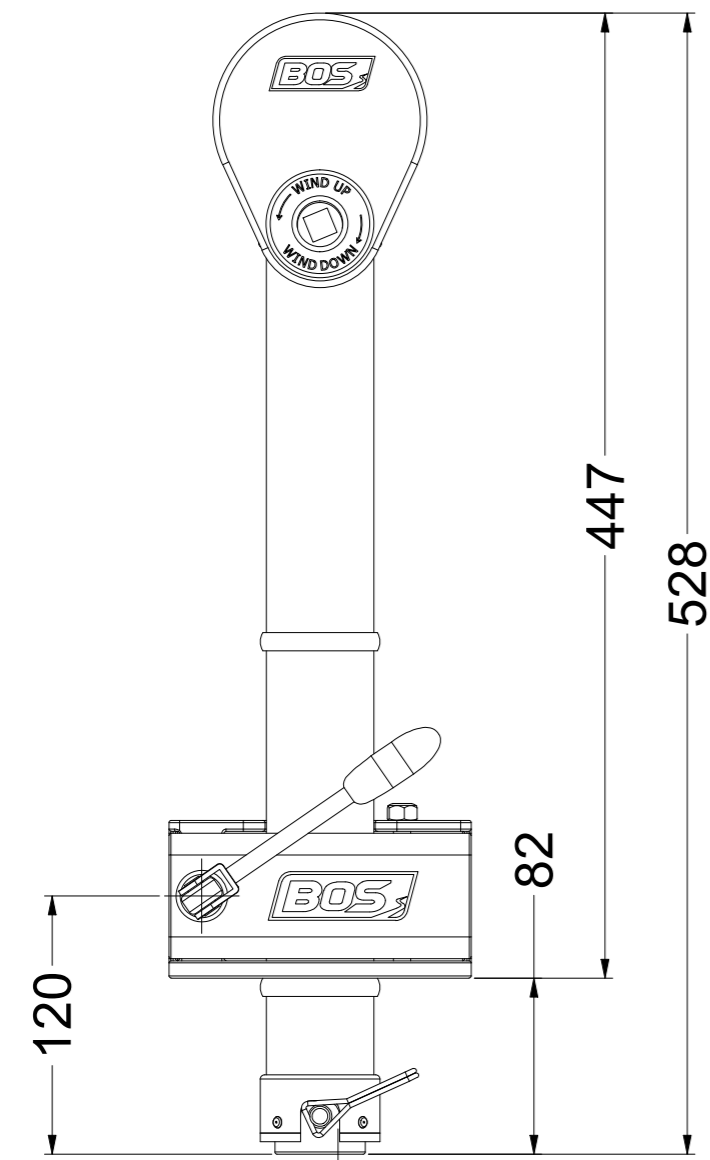

Retracted with Base Plate

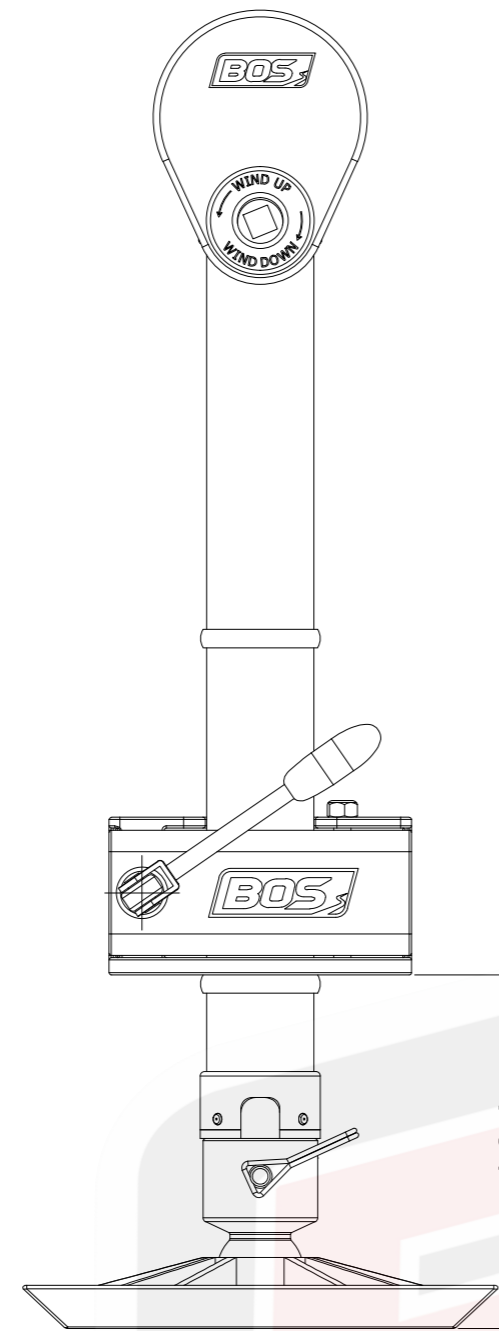

Maximum Extension with Base Plate

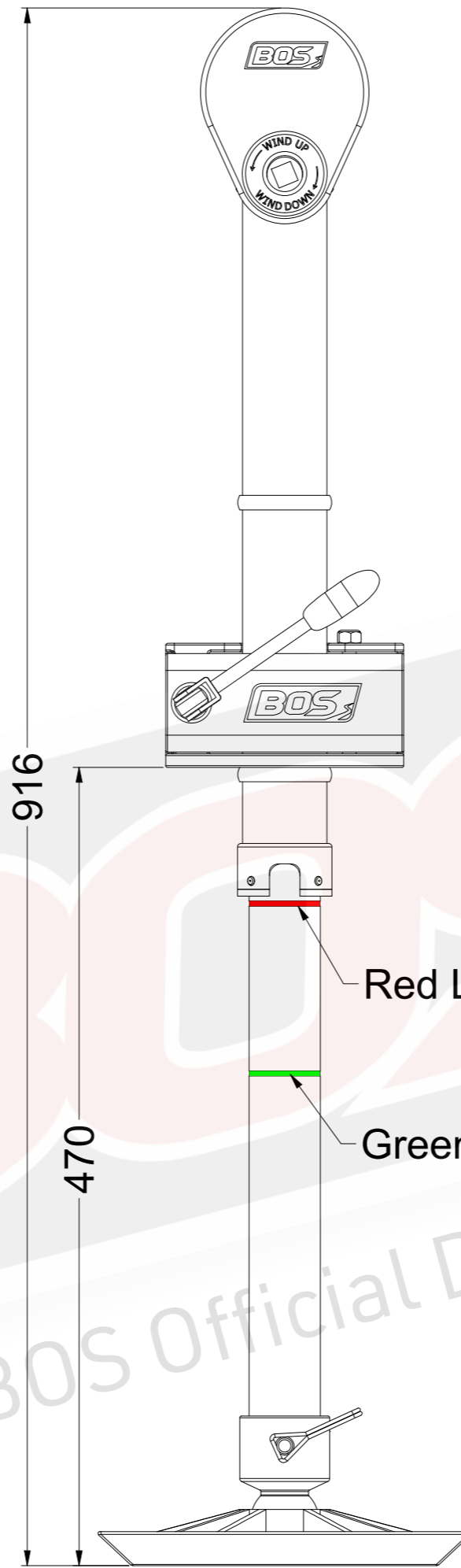

Maximum Extension with 120mm Extension & Base Plate

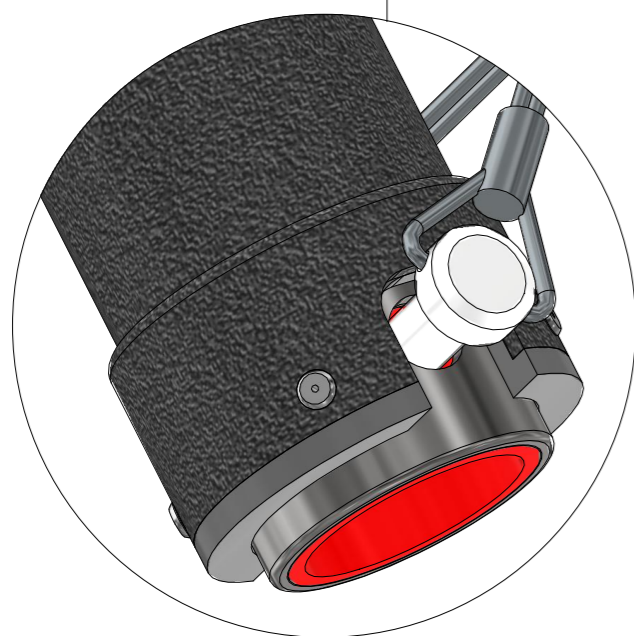
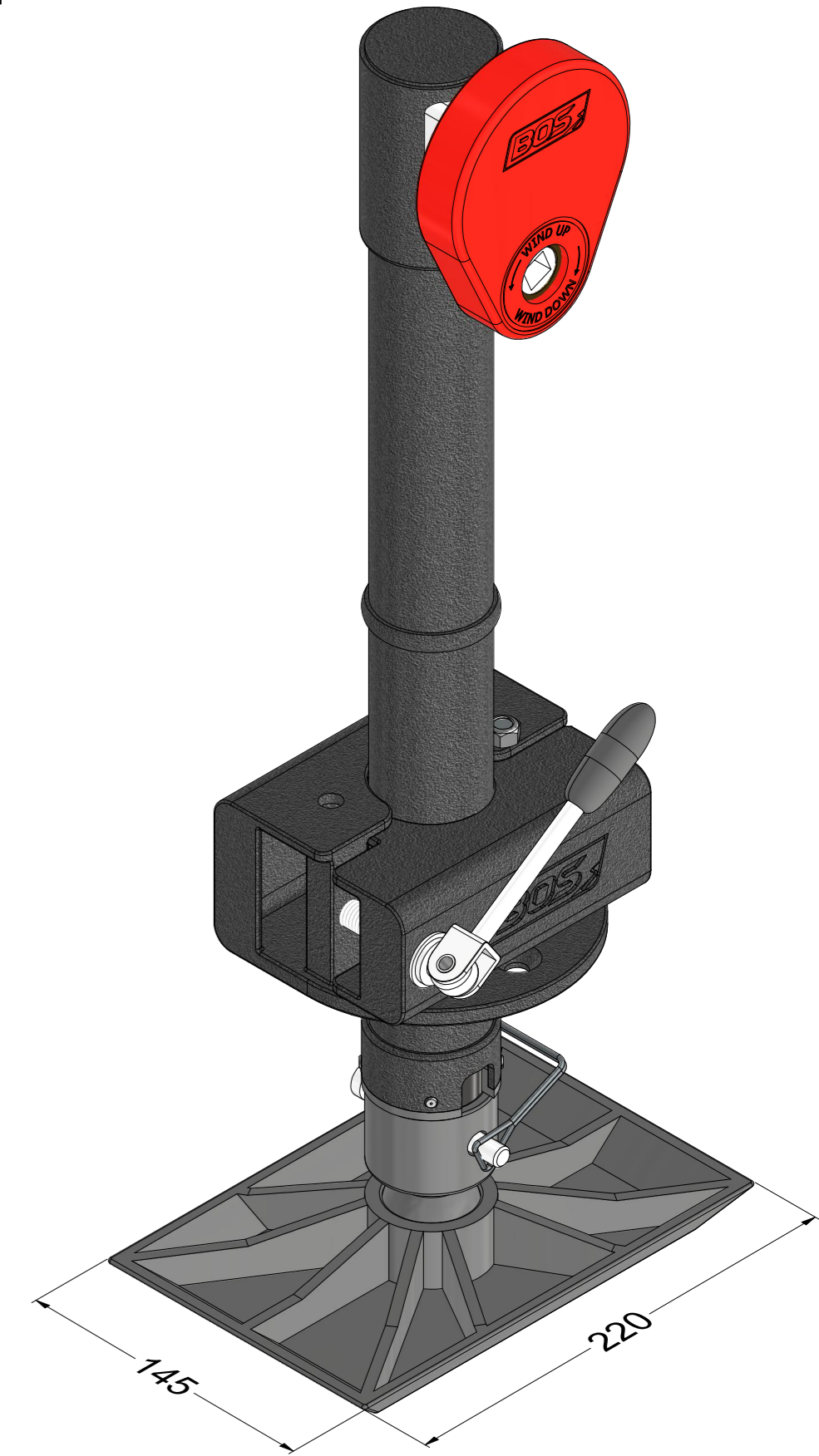
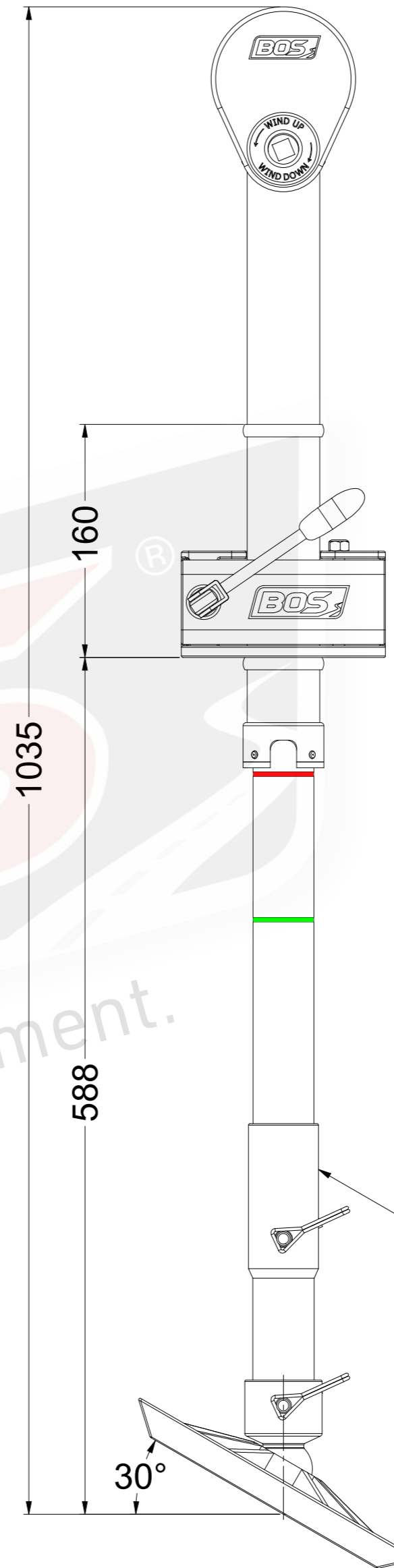

Fully retracted with Lynch Pin to leave on while travelling

BOS Side Winder Jockey Unit and Base Plate with Centre Mounted Clamp



PART NO.: 572-025

DO NOT SCALE DRAWING SHEET:

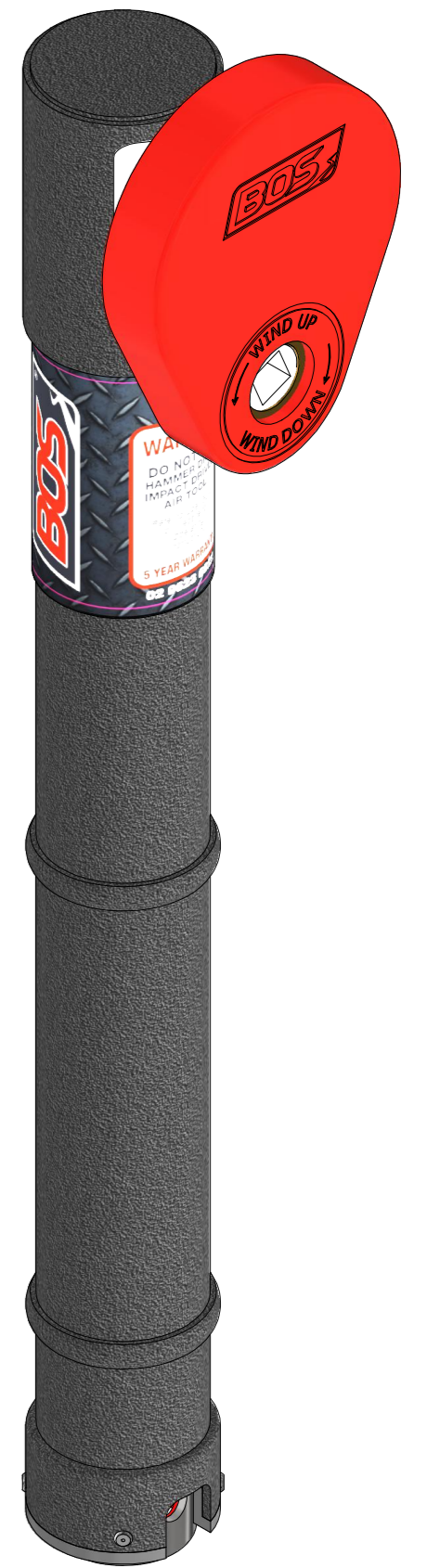
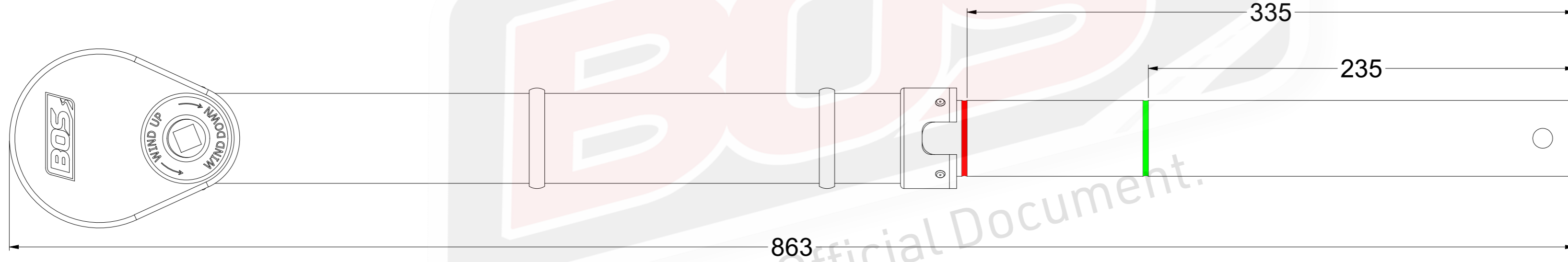
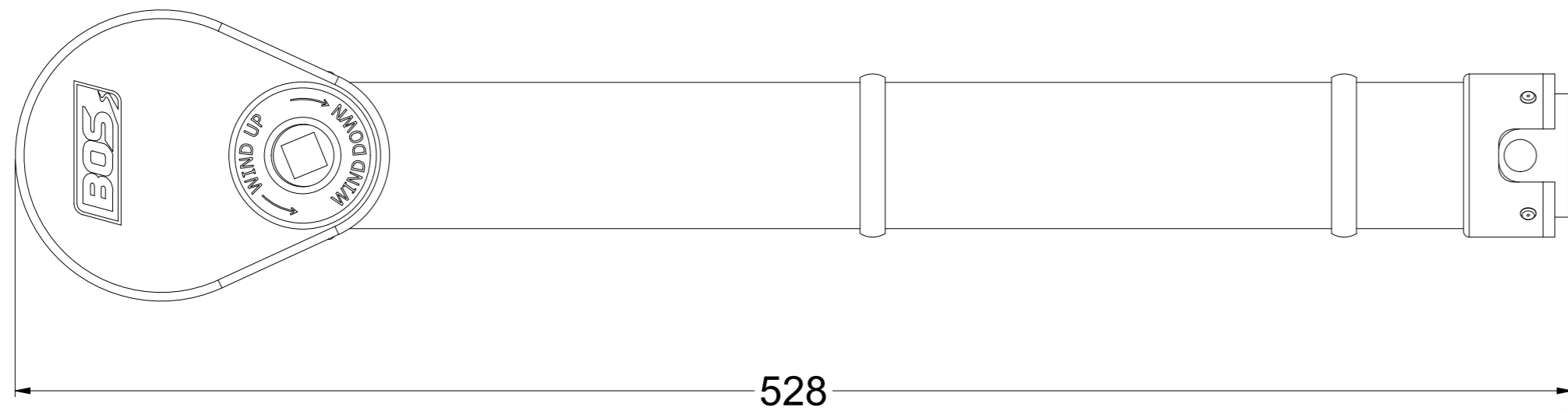

Travel: 330mm
 Weight of the Unit: 5Kg



PART NO.:
572-002
 DO NOT SCALE DRAWING SHEET:
 8

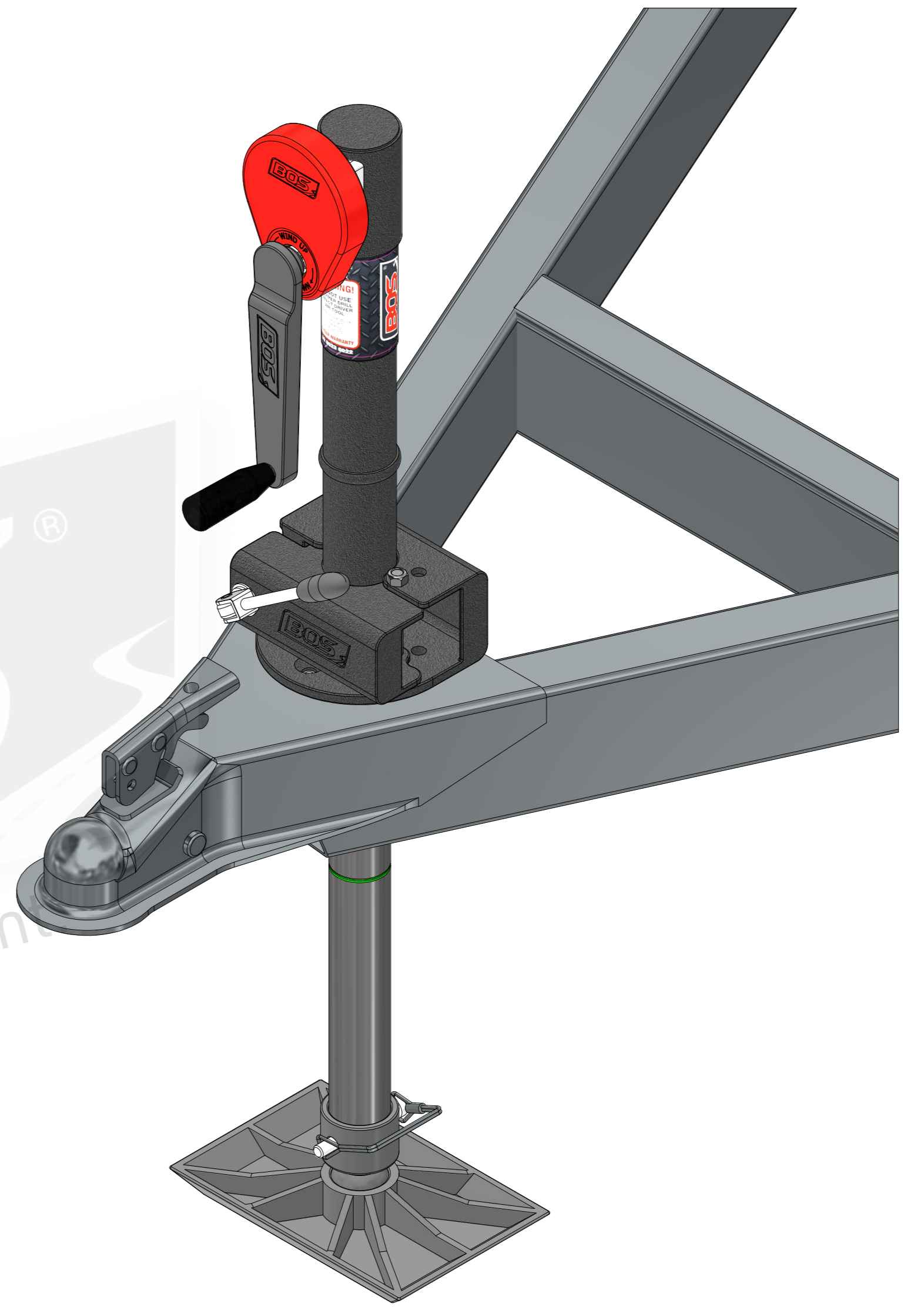
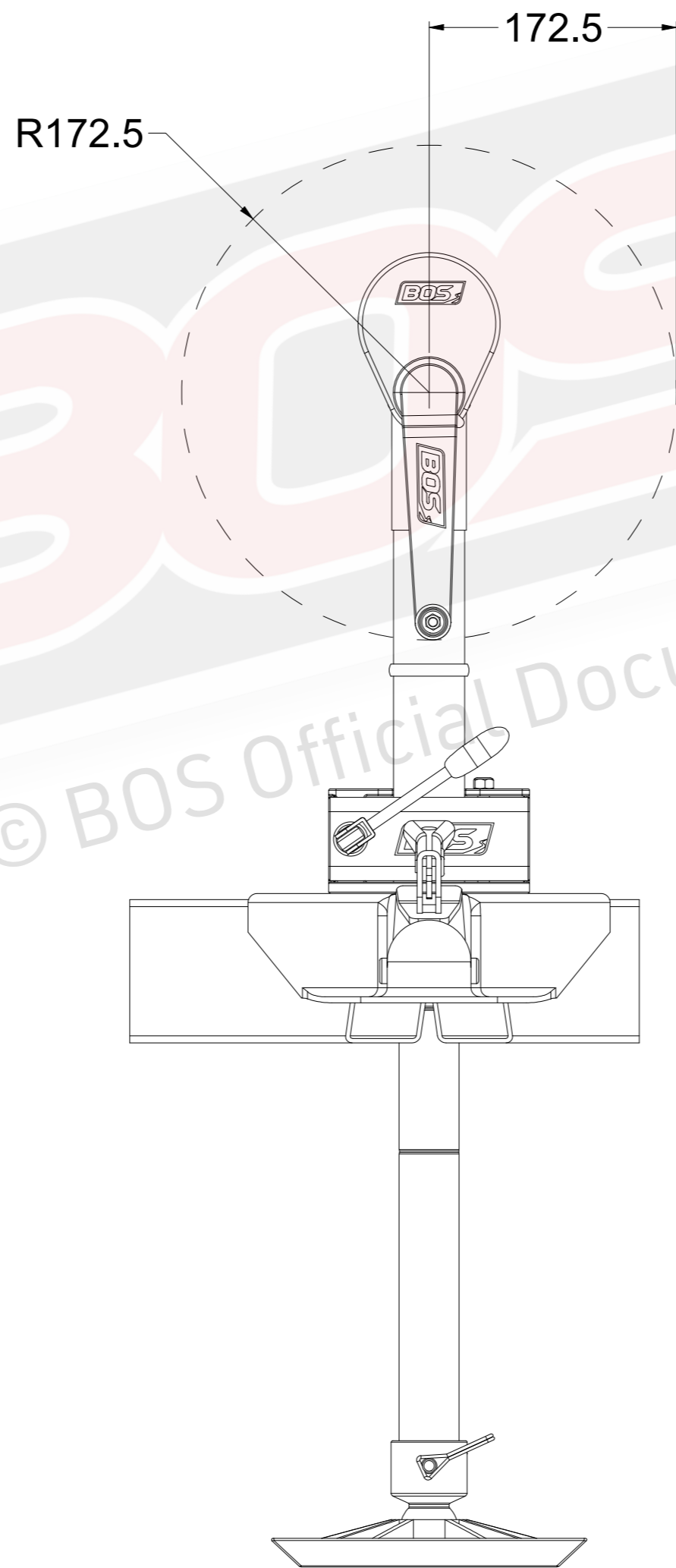
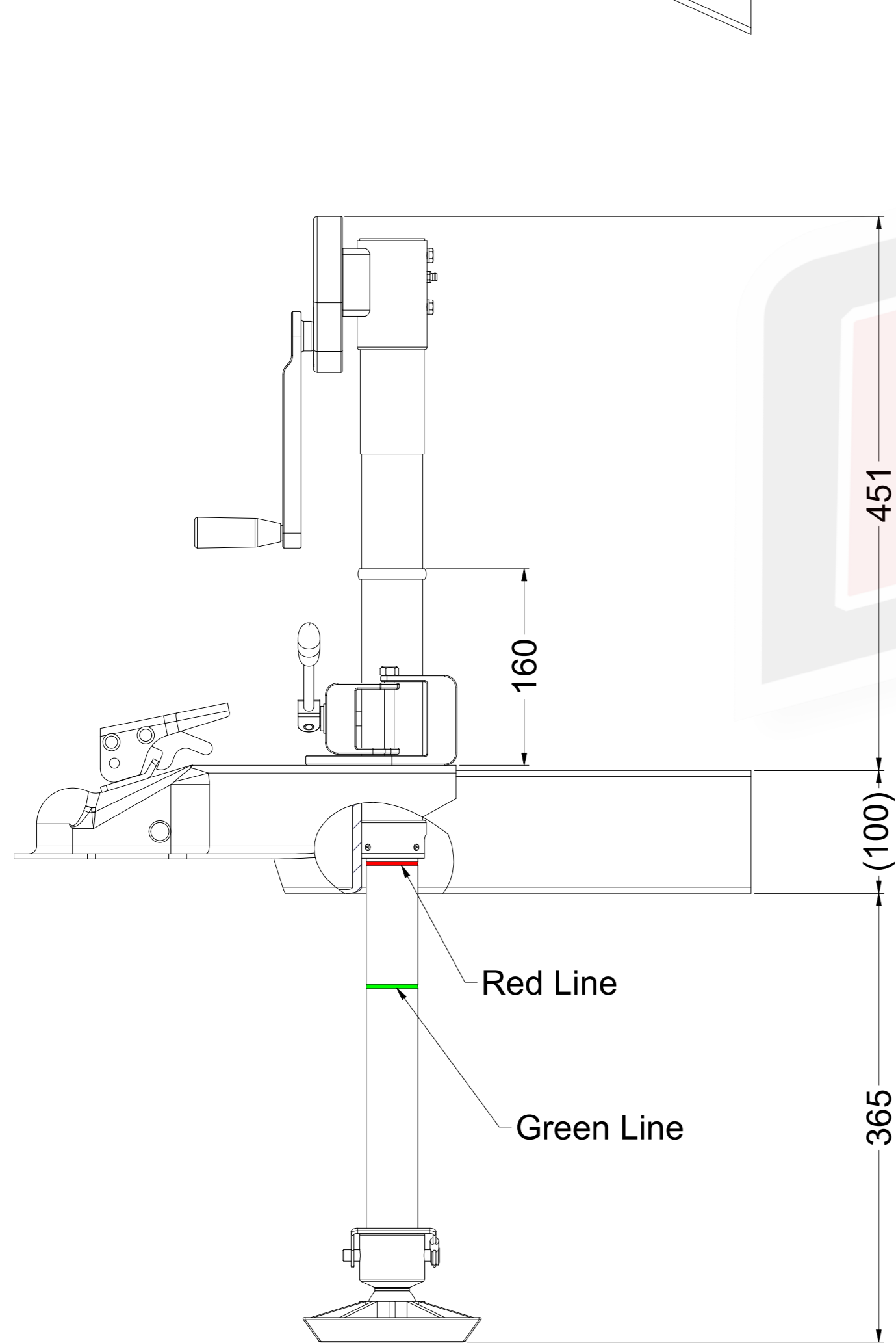
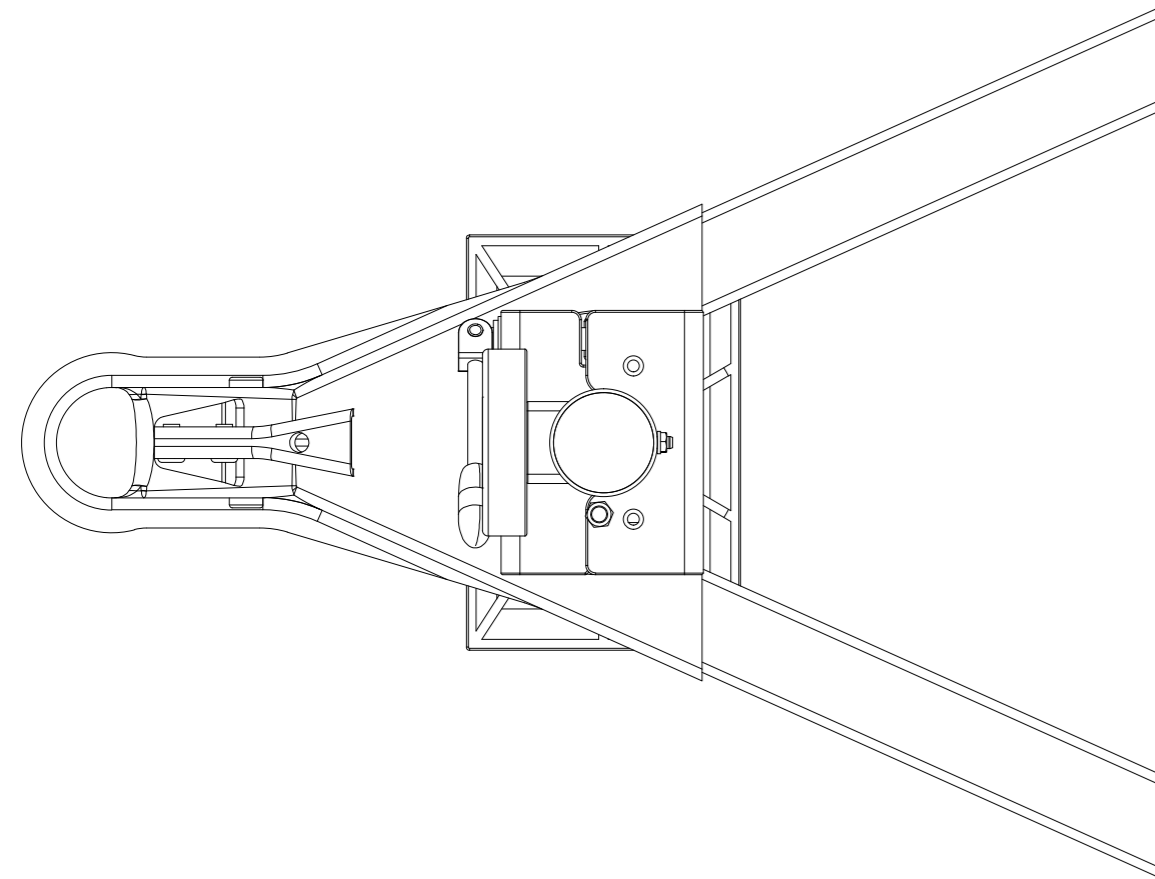

PART NO.:
572-025

DO NOT SCALE DRAWING SHEET:
8

8 7 6 5 4 3 2 1

Note:
Bolts Supplied with Mounting Kit

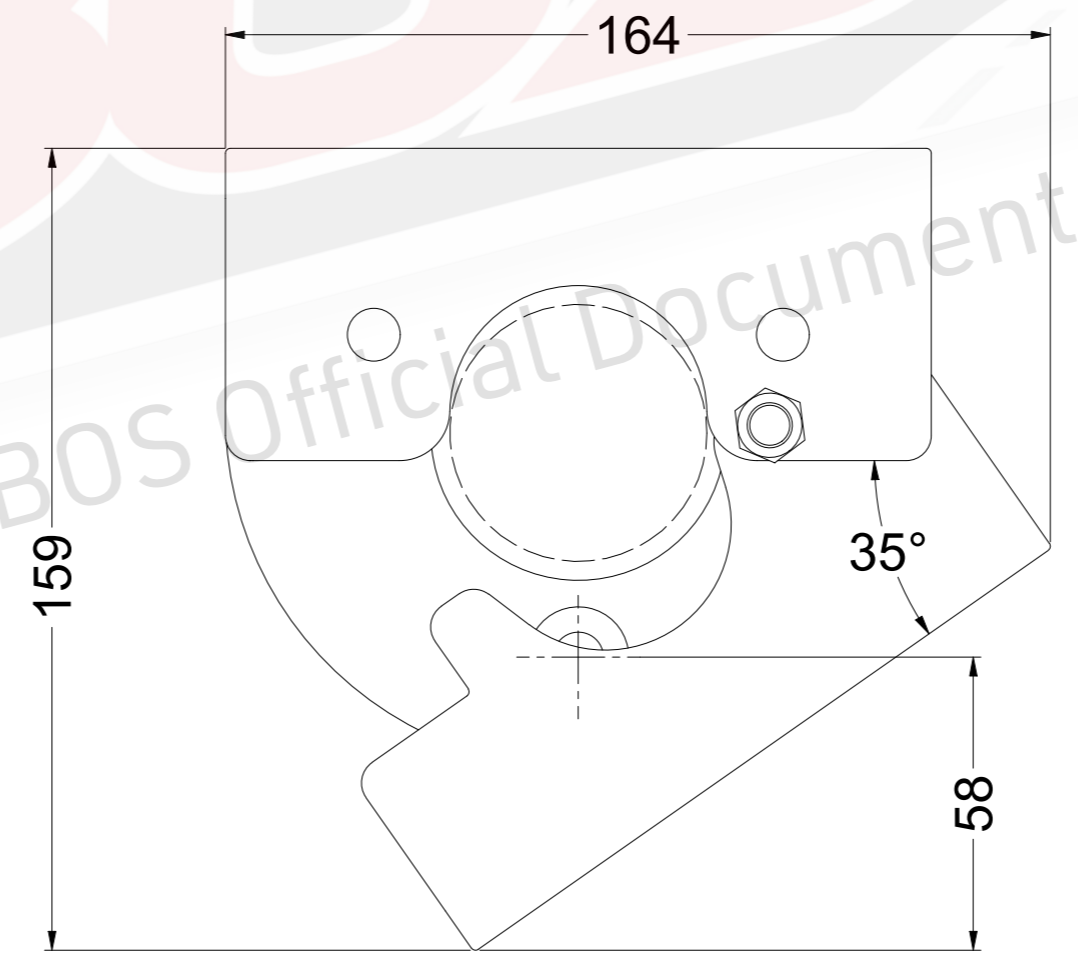
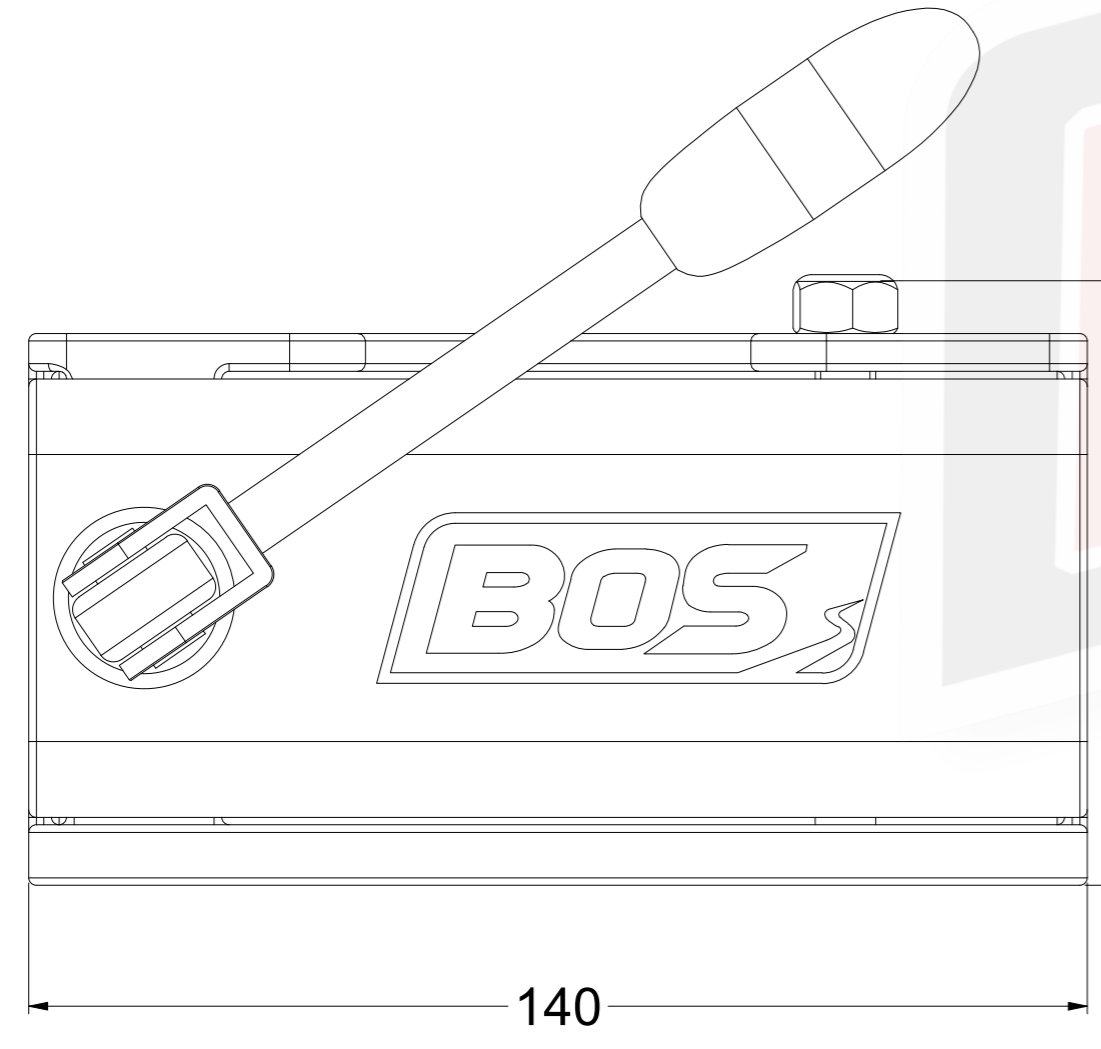
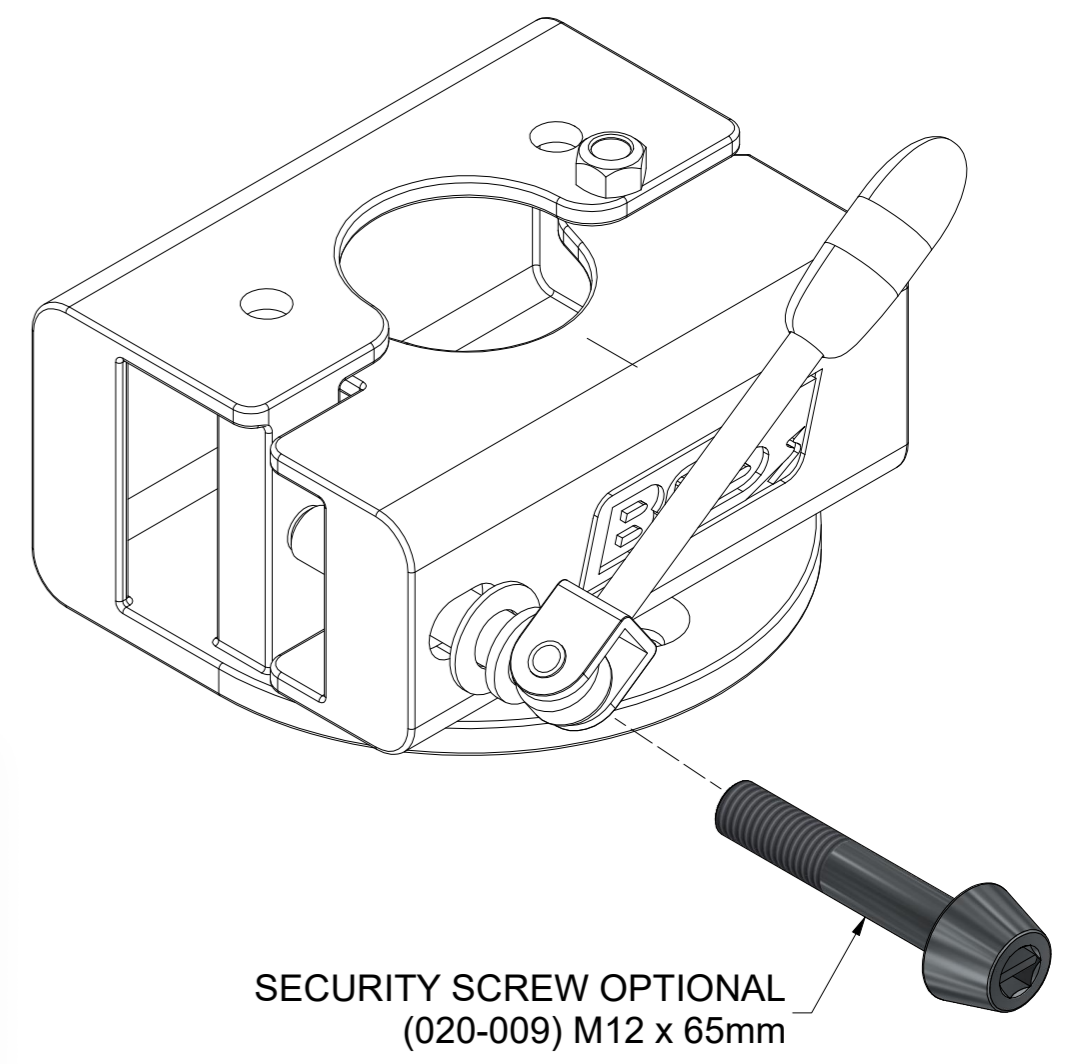
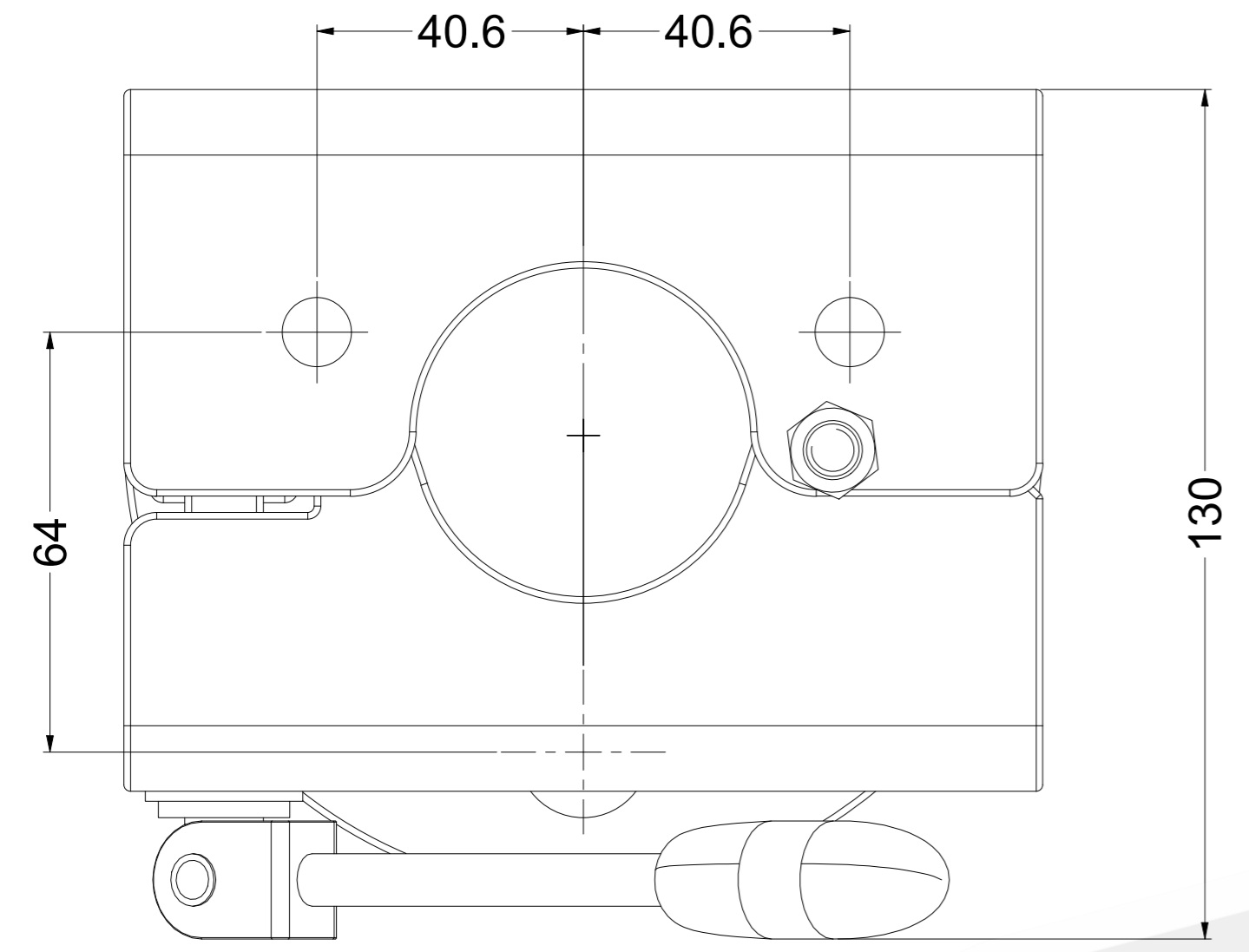

Minimum clearance required to fit Jockey Unit when Clamp is opened

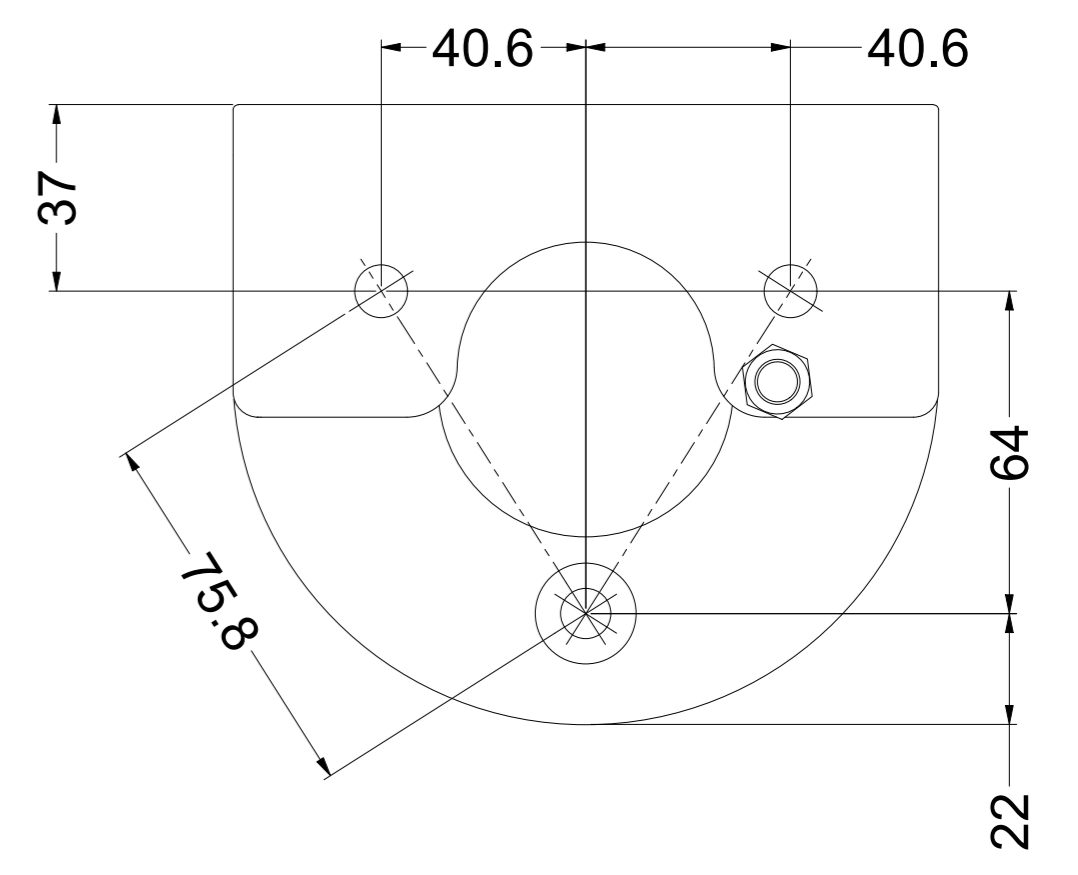

Mounting Holes Detail



PART NO.:	
DO NOT SCALE DRAWING	SHEET:

8 7 6 5 4 3 2 1

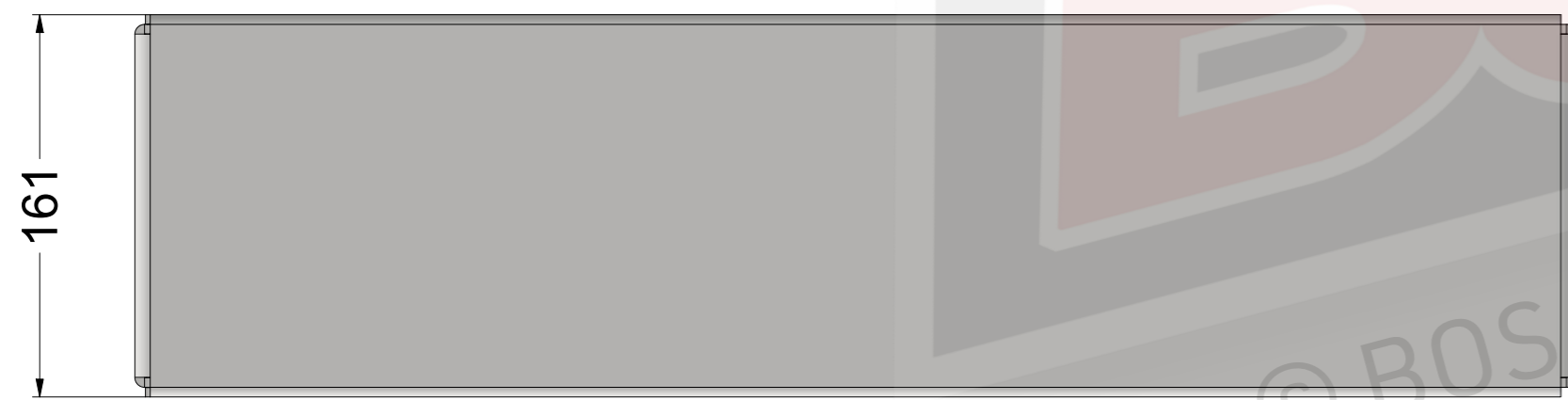
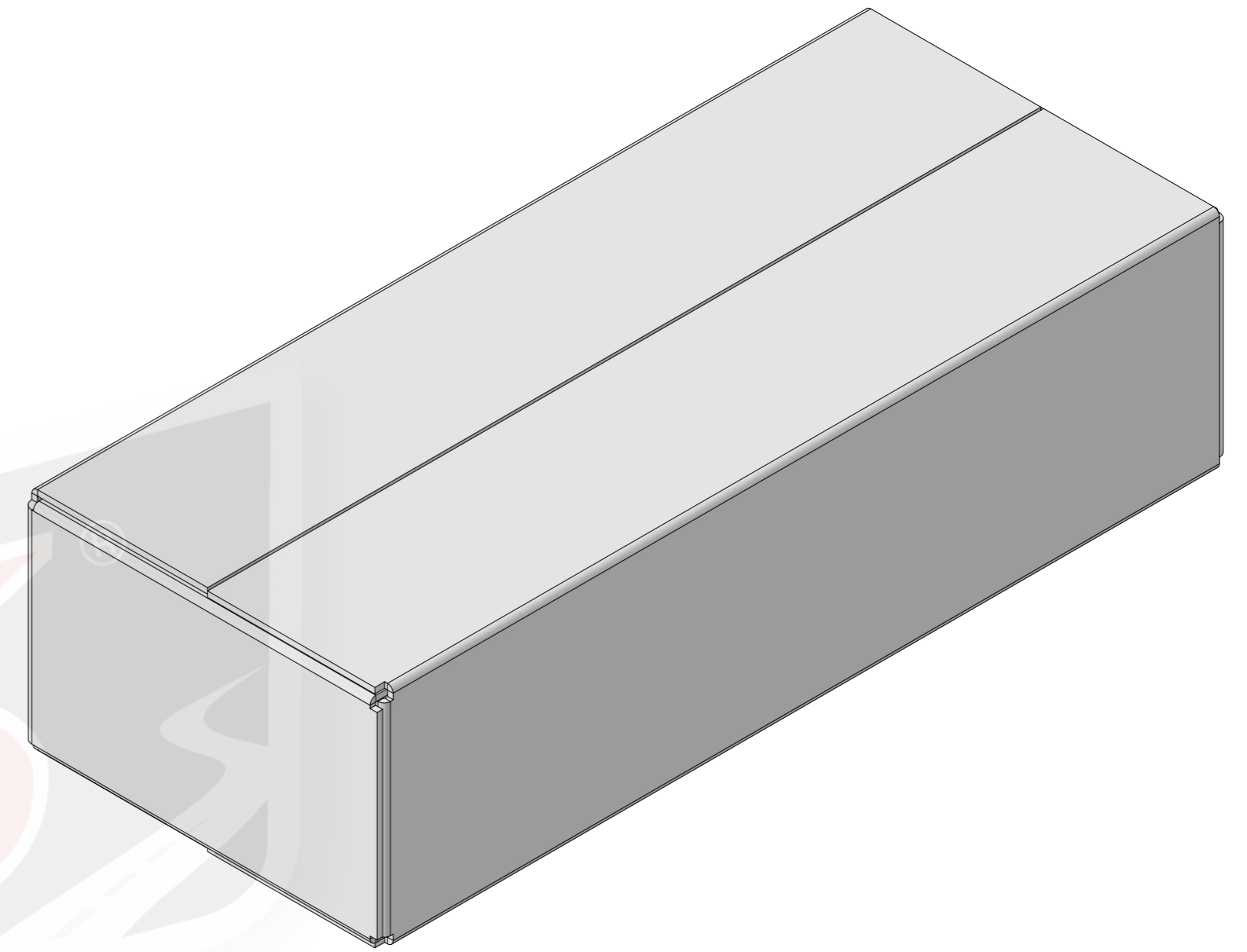
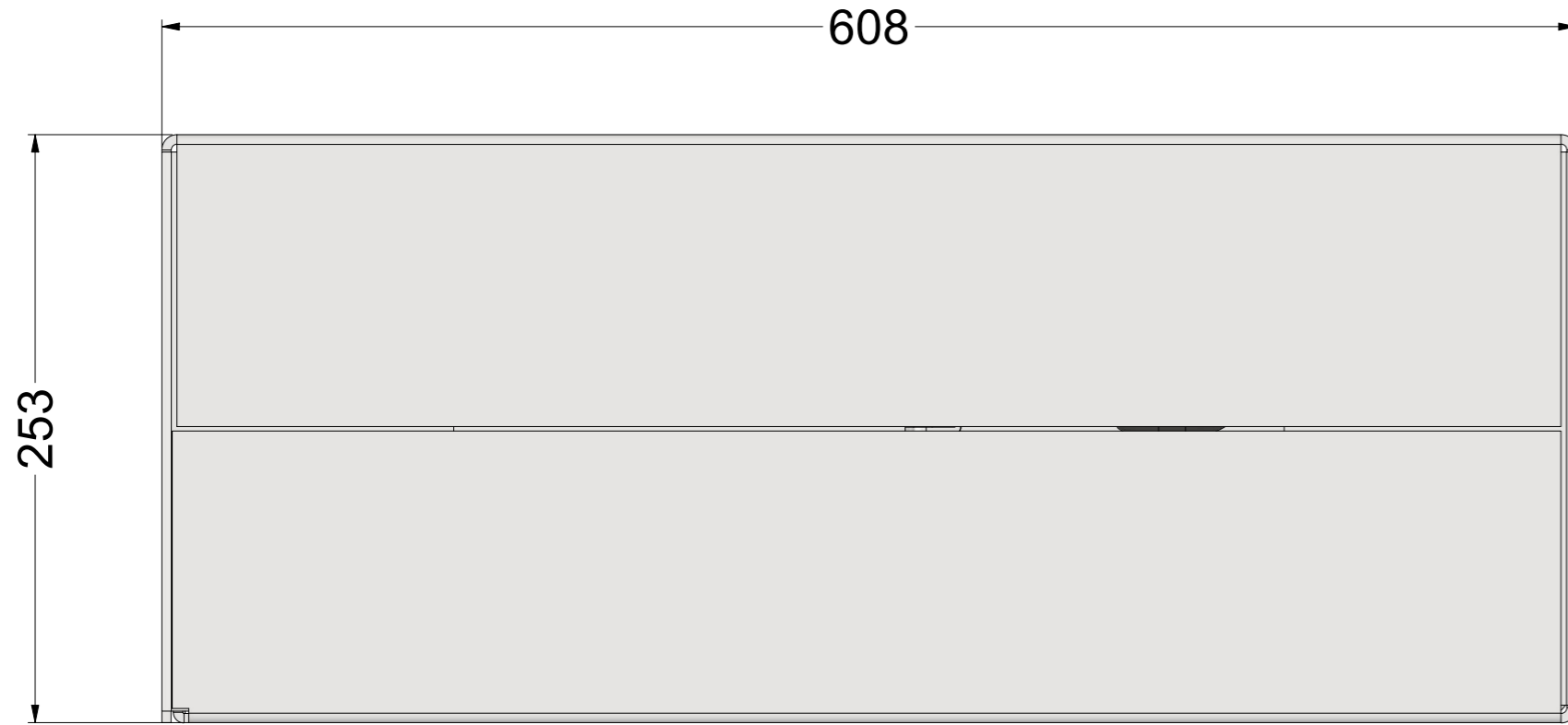

Length = 608mm / 24 Inch
Width = 253mm / 10 Inch
Height = 161mm / 6.5 Inch
Weight = 9.9Kg / 21.9Lbs



PART NO.:
572-025

DO NOT SCALE DRAWING SHEET: